



RIGHT OF WAY ENCROACHMENT AGREEMENT APPLICATION

Contact Information:

Applicant/Owner Craftwell Architecture + Construction / Creedence Energy

Mailing Address 2534 University Drive South, Suite #3, Fargo, ND 58103

Phone 701-478-4600 Email Kendall@wecraftwell.com

Application Information:

Address of Requested Encroachment 21 East Central Ave., Minot, ND 58701

Legal Description of Property Original Minot Addition East 60' of Lots Lots  
16, 17, 18, 19, & 20 Block 19

Briefly describe the reason for this request The existing building main floor elevation  
and adjacent exterior sidewalk have a difference in elevation of approximately  
2'-6". Being as though this is the main or central entrance to the building we  
are requesting the installation of the proposed 4'-5" wide ADA ramp /  
accessible entrance. Thereby maintaining a 4'-1" wide ADA sidewalk corridor.

Kendall Andrus

Signature of Applicant

July 9, 2020

Date

\*\$100.00 processing fee will be required before recording of encroachment (after City Council approval).

SUPPLY PLOT PLAN OF ENCROACHMENT REQUEST  
(Show amount of encroachment into right of way)

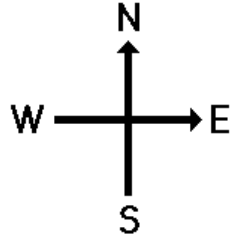



2534 UNIVERSITY DRIVE SOUTH #3  
FARGO, ND 58103  
701.478.4600

I HEREBY CERTIFY THAT THIS PLAN, SPECIFICATION, OR REPORT WAS PREPARED BY ME OR UNDER MY DIRECT SUPERVISION AND THAT I AM A DULY REGISTERED ARCHITECT UNDER THE LAWS OF THE STATE OF NORTH DAKOTA

SIGNATURE: *[Signature]*  
DATE: 2/9/2020, REG. NO. 1917

CODE PLAN LEGEND	
.....	1 HR FIRE PARTITION
-----	2 HOUR FIRE BARRIER

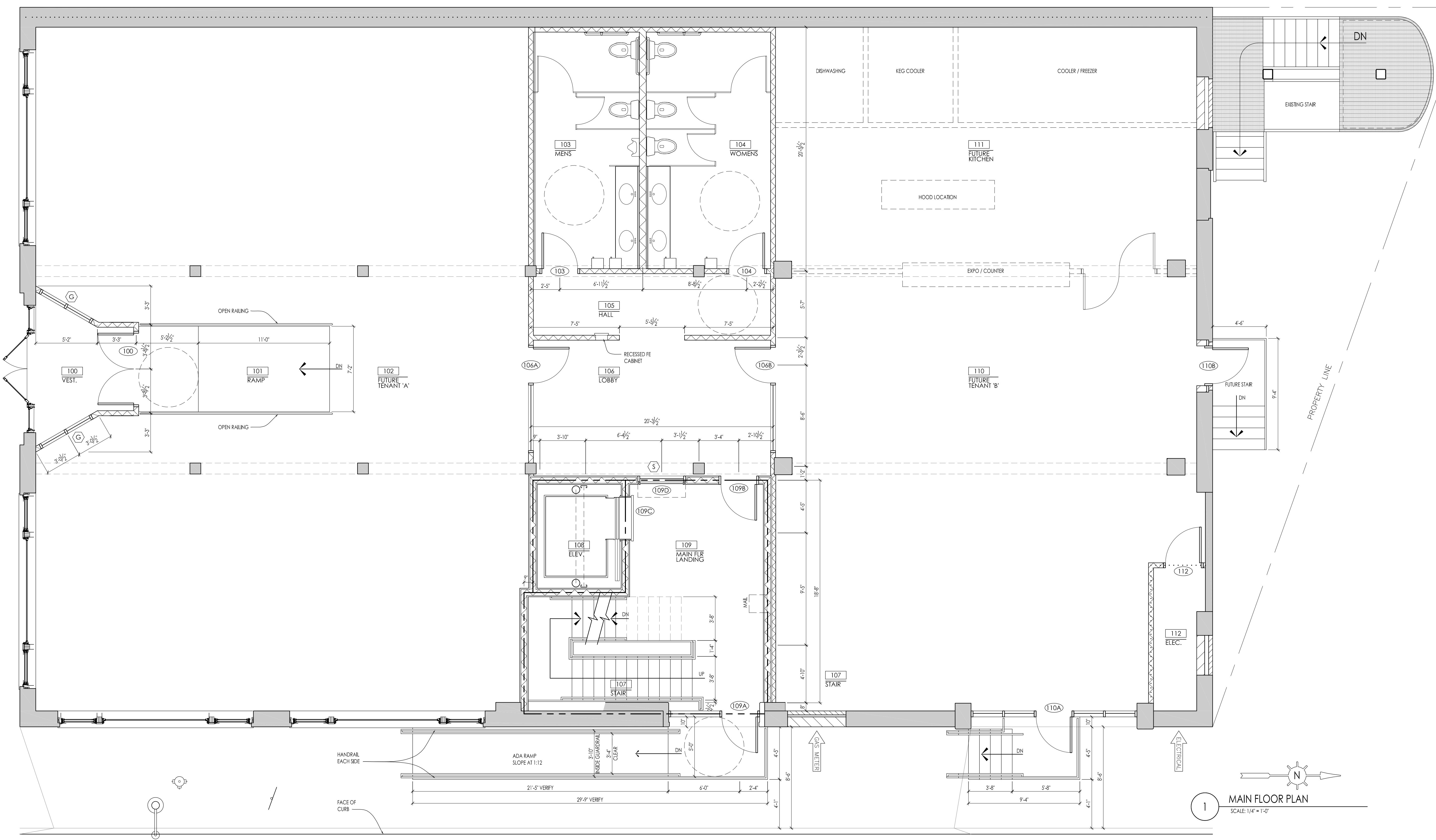

**CREEDENCE ENERGY**  
21 CENTRAL AVE. EAST MINOT, NORTH DAKOTA

DATE: 07-09-2020  
PROJECT: 19007

PHASE:  
CONSTRUCTION  
DOCUMENTS

**A301**  
MAIN LEVEL  
FLOOR PLAN

1 MAIN FLOOR PLAN  
SCALE: 1/4" = 1'-0"