

- NOTES:**
1. ALL WORK SHALL CONFORM TO THE 2021 CITY OF MINOT STANDARD SPECIFICATIONS AND DETAILS.
 2. GRATES AND FRAMES FOR STMH-1 & STMH-2 WILL BE NEENAH R-1642, LID TYPE B, LETTERED "STORM SEWER," WITH 2 CONCEALED PICK HOLES TYPE F.

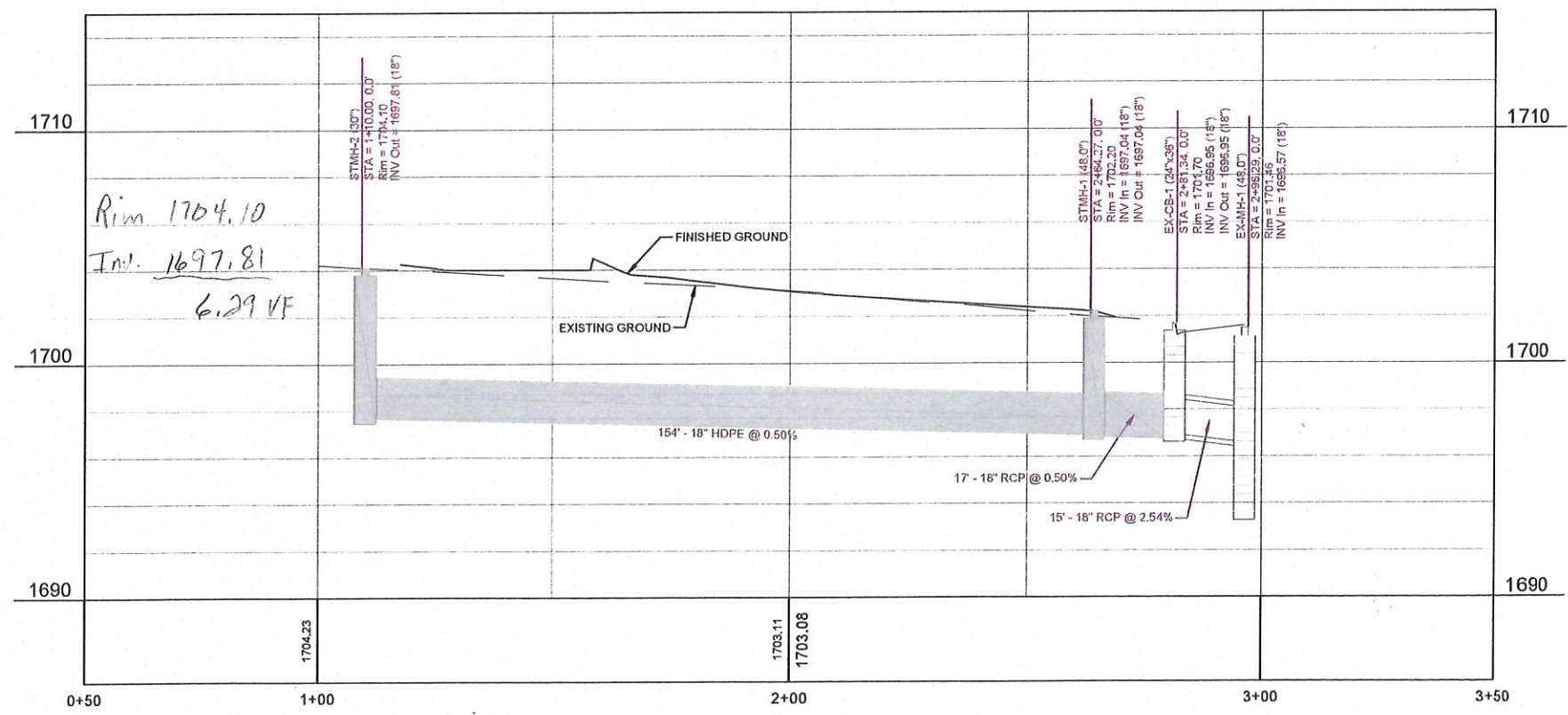

Rim 1702.20
 Inv. In 1697.04
 Inv. Out 1696.95
 5.25 VF
 +.25 for wall thickness
 5.5 = 66"

VERTICAL DATUM: NAVD88

NO.	REVISIONS	BY	DATE	APPR.

ACKERMAN ESTVOLD
 1907 17th St SE · Minot, ND 58701
 701.837.8737 · www.ackerman-estvold.com
 Minot, ND | Fargo, ND | Williston, ND | Bismarck, ND

SCALE (H): 1" = 30'
 SCALE (V): 1" = 6'
 DRAWN BY: DPW
 DESIGNED BY: DPW
 CHECKED BY: RBA
 DATE: 05/24/2021

MEADOWLARK HOLDINGS, LLC
 21ST AVENUE SE STORM SEWER EXTENSION
 MINOT, NORTH DAKOTA
 STORM SEWER PLAN & PROFILE

Project NO.
R21047
 Drawing Name
STORM P&P
 C01 OF C01

CONSTRUCTION SET